

## CPVC HOT & COLD WATER PIPE & FITTINGS

100 PSI @ 180°F Max. Working Pres./Temp.

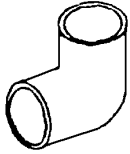

90° Ell



45° Ell



Cap

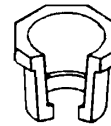

Bushing

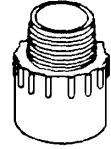

Male Adapter

### Fittings

	1/2"	3/4"	1"	3/4" x 1/2"	1" x 3/4"
Coupling	\$ .81	1.09	4.93	1.76	5.91
Bushing				1.23	4.12
Tee	1.29	2.41	12.12	2.49	
90° Elbow	1.01	1.65	4.84	2.95	
* Male Adapter	20.33	22.57	33.63		
* Female Adapter	15.82	17.42	22.06		
Slip Cap	.90	1.15	4.17		
Insulators	.40	.71	.85		
Insulated Hanger	.45	.55	.65		
Drop Ear Hanger	.35	.45	.75		
PVC-CPVC Adapter		3.78	7.17		
45° Elbow	1.26	2.21	5.60		
90° Street Elbow	1.18	1.90	8.65		
Nail Clamps	.47	.50			
* Drop Ear 90° S x Fip	11.56				

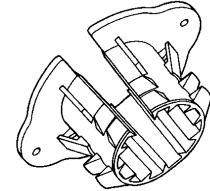

Insulator

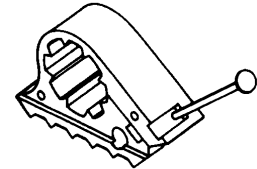

Nail Clamp

\* Stainless Steel Reinforced

### Stainless Steel Reinforced Threads



Drop Ear S x F 90°



Male Adapter



Female Adapter

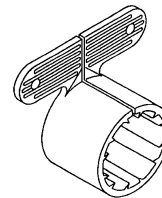

Drop Ear Hanger

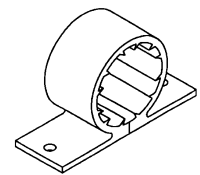

Insulated Hanger

	1/2"	3/4"	1"
<b>PIPE</b>	\$ .90 /Ft	1.62 /Ft	3.33 /Ft

10' Section: