

## WATER CLOSET PARTS

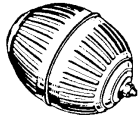

4 x 5 Plastic Float	\$ .95
---------------------	--------

8" Brass Float Rod	\$ 3.75
10" Brass Float Rod	3.75
12" Brass Float Rod	4.65



Standard Tank lever	5.65
---------------------	------

Brass Douglas Flush Valve	31.05
Plastic Douglas Flush Valve	9.75

Br. Upper lift wire	2.05
Br. Lower lift wire	1.45
Br. Reg. wire guide	4.25

#102 Closet Bolt Set	\$ 2.50
#237 Tank-to-Bowl Kit	5.75
#439 Tank-to-Bowl Kit*	7.05

\* w/sponge washer



### Closet Spuds (Brass)

1", 1 1/4" x 3/4"	\$ 8.75
1 1/4", 1 1/2" x 1 1/2"	11.45
2", 2" Red X 2"	15.25

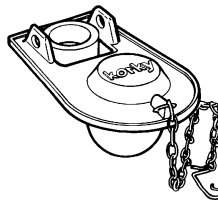
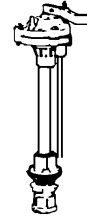
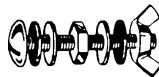
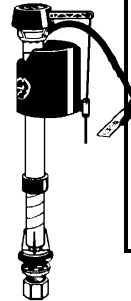
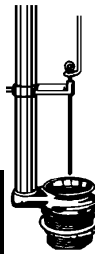
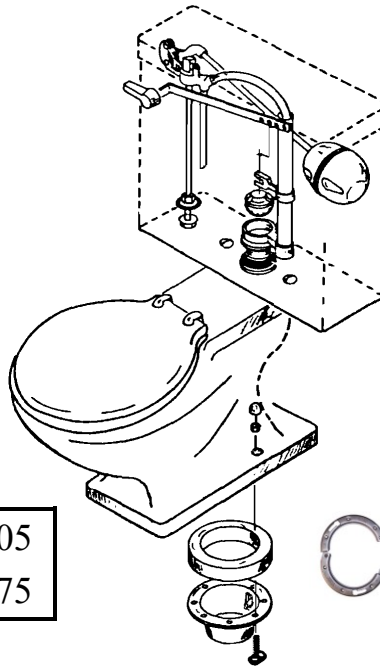

### Closet Wax Rings

4" Regular	\$ 2.15
4" x 3" w/horn	2.75
4" x 3" w/horn *(#3)	6.15
4" x 4" w/horn *(#4)	5.95
4" x 3" w/horn Thick*(#10)	5.15
4" x 3" w/horn + Bolts	6.05
4" Thick Wall Closet *(#5)	8.95
Urethane-Wax Urinal*(#6)	7.95

\* = 10year Guarantee



### Closet Flange Repair

Quick-Ring Flg Repair	\$ 10.15
Quick-Floor Repair	19.95
Stainless Steel ring Solid	7.75
Stainless Steel ring Adj.	16.60
Stainless Steel ring "Clam"	17.75
Pl. Flange Extension	4.95

### Ballcocks

528P Hunter	\$ 14.75
Pro45B Fluidmaster	22.55
#435 3" Universal Seal Kit	9.50
#450 A/S Campion4 Seal Kit	9.00
#Pro54 -Fluidmaster Flapper	5.95
#2001-Red Korky Flapper	5.95
#3060 3" Universal Flapper	18.45



↖ Bolts ↗

↖ Screws ↗

Closet Nuts

	x 2 1/4"	x 3 1/2"	x 2 1/2"	x 3 1/2"	
1/4"	\$ .89	1.25	1.35	2.10	.68
5/16"	1.55	2.15			.80



Br. Closet Washers	\$ .45
Plastic Bolt Caps/ pr	.60