

## WARDFLEX PIPE & FITTINGS



Coupling

### PIPE

	1/2"	3/4"	1"
<b>50'</b>	\$ 300.49	392.18	559.24
<b>100'</b>	600.99	784.39	1,118.48

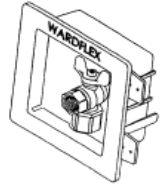

Gas Valve Box

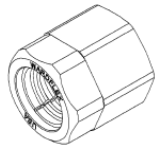

Female Adapter

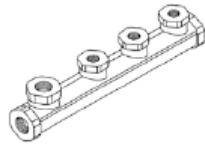

Iron Manifold

### FITTINGS

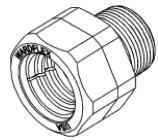

Male Adapter

	1/2"	3/4"	1"
Coupling (W x W)	\$ 47.45	65.28	105.35
Tee (W x W x W)	79.72	98.84	194.16
Tee (W x W x Fip)	55.31	112.05	200.60
Male Adapter (W x Mip)	25.77	35.14	58.33
Female Adapter (W x Fip)	24.22	34.88	51.06
Strip-wound Hose (12")	4.48	7.09	

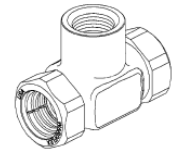

Fip Mechanical Tee

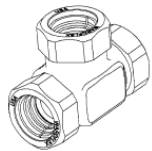

Mechanical Tee

Indoor Termination	39.16	43.24	63.05
Outdoor Termination	43.74	51.61	71.48
Appliance Stub-Out	27.31	30.61	
Meter Stub-Out (6")	26.97	27.56	

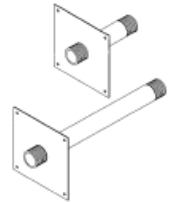

Meter Stub-out



Appliance Stub-out

Tee (3/4W x 3/4W x 1/2W)	99.03	1.84	Striker Plate - Quarter
Tee (3/4W x 1/2W x 1/2W)	116.64	3.61	Striker Plate - Half
Tee (1W x 1W x 1/2W)	194.16	7.53	Striker Plate - Full
Tee (1W x 1W x 3/4W)	223.68	3.61	Striker Plate - Double
Tee (1W x 3/4W x 3/4W)	142.93		
Tee (1W x 3/4W x 1/2W)	140.29		
Gas Valve Box (1/2")	91.40	99.00	#32078 Ridgid Cutter (3/8"-1" Pipe)

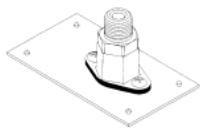
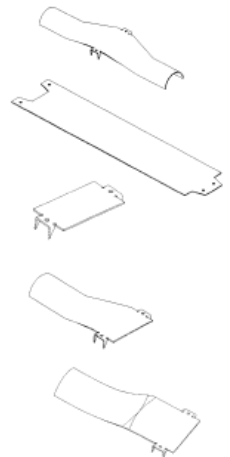

Indoor Termination

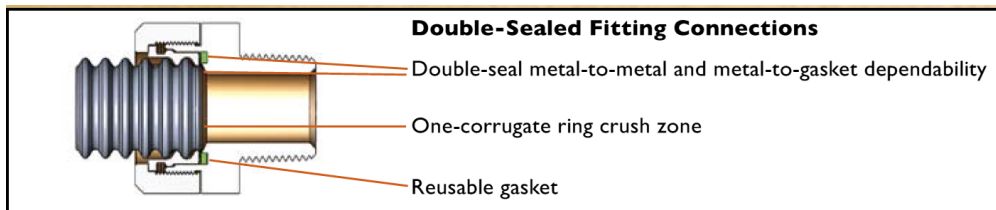

<b>1</b> Cut Wardflex tubing and remove PE coating to expose a minimum of 4 corrugations.	<b>2</b> Slide nut over tubing and place retainer ring. Leave 1-corrugation exposed on the end of tubing.	<b>3</b> Slide nut over retainer ring and hand-tighten nut to body.	<b>4</b> Tighten with wrenches until nut contacts body.
--	--	--	--

## NATURAL GAS

**Table A-2**

Maximum Capacity of WARDFLEX Corrugated Stainless Steel Tubing in Cubic Feet of Gas per Hour for:  
Gas Pressure: 0.5 PSI or less Pressure Drop: 0.5 inches Water Column (Based on 0.60 specific gravity gas)\*

LENGTH OF TUBING RUN	TUBING SIZE & EHD						
	10A (3/8") 15	15A (1/2") 19	20A (3/4") 25	25A (1") 30	32A (1 1/4") 37	38A (1-1/2") 48	50A (2") 62
5 feet	63	134	270	471	873	2073	3993
10 feet	44	95	192	330	625	1473	2880
15 feet	36	77	157	268	514	1206	2379
20 feet	31	67	137	231	447	1046	2077
25 feet	27	60	122	206	402	937	1870
30 feet	25	55	112	188	368	857	1716
40 feet	21	47	97	162	320	743	1498
50 feet	19	42	87	144	288	666	1348
60 feet	17	39	80	131	263	609	1237
80 feet	15	33	69	113	230	528	1080
100 feet	13	30	62	101	206	473	972
150 feet	10	24	51	82	170	387	803
200 feet	9	21	44	71	147	336	701
300 feet	7	17	36	57	121	275	579
500 feet	5	13	28	44	94	214	455

\*Table includes losses for four 90 degree bends and 2 end fittings. To compute flow capacity for tubing runs with a larger number of bends and/or fittings, add the appropriate number of feet to the actual run length using the following formula:

$$L = 1.3(n) \quad L = \text{Numbers of feet to be added to actual run length.} \quad n = \text{Number of bends and/or fittings over six.}$$

## PROPANE

**Table A-8**

Maximum Capacity of WARDFLEX Corrugated Stainless Steel Tubing in KBTU per Hour for:  
Gas Pressure: 0.5 PSI or less Pressure Drop: 0.5 Inches W.C. (Based on 1.52 specific gravity gas)\*

LENGTH OF TUBING RUN	TUBING SIZE & EHD						
	10A (3/8") 15	15A (1/2") 19	20A (3/4") 25	25A (1") 30	32A (1-1/4") 37	38A (1-1/2") 48	50A (2") 62
5 feet	100	212	427	745	1380	3277	6312
10 feet	70	150	304	522	988	2328	4553
15 feet	57	122	248	424	812	1906	3761
20 feet	49	106	217	365	707	1653	3283
25 feet	43	95	193	326	635	1481	2956
30 feet	40	87	177	297	582	1355	2713
40 feet	33	74	153	256	506	1175	2368
50 feet	30	66	138	228	455	1053	2131
60 feet	27	62	126	207	416	963	1955
80 feet	24	52	109	179	363	835	1707
100 feet	21	47	98	160	325	748	1536
150 feet	16	38	81	130	268	612	1269
200 feet	14	33	70	112	233	531	1108
300 feet	11	27	57	90	191	435	915
500 feet	8	21	44	70	149	338	719

\*Table includes losses for four 90 degree bends and 2 end fittings. To compute flow capacity for tubing runs with a larger number of bends and/or fittings, add the appropriate number of feet to the actual run length using the following formula:

$$L = 1.3(n) \quad L = \text{Numbers of feet to be added to actual run length.} \quad n = \text{Number of bends and/or fittings over six.}$$

### Natural / Propane Gas IPS Pipe Capacity (MBH ≈ CFH)

Gas Pressure 0.5psi or less (11"wc for LP) – Pressure Drop: 0.5in water Column

Pipe Size (in)		Pipe Length (ft)					
Nominal	Pipe ID	10'	20'	40'	60'	80'	100'
1/2"	0.622	170 / 275	118 / 189	80 / 129	64 / 103	55 / 89	49 / 78
3/4"	0.824	360 / 567	245 / 393	169 / 267	135 / 217	115 / 185	102 / 192
1"	1.049	670 / 1071	430 / 732	318 / 504	255 / 409	220 / 346	192 / 307
1 1/4"	1.380	1320 / 2205	930 / 1496	640 / 1039	510 / 834	440 / 724	390 / 630